

1 2 3 4 5 6 7 8

A

B

C

D

E

A

B

C

D

E

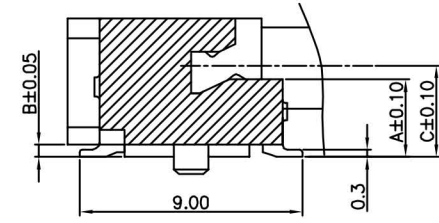
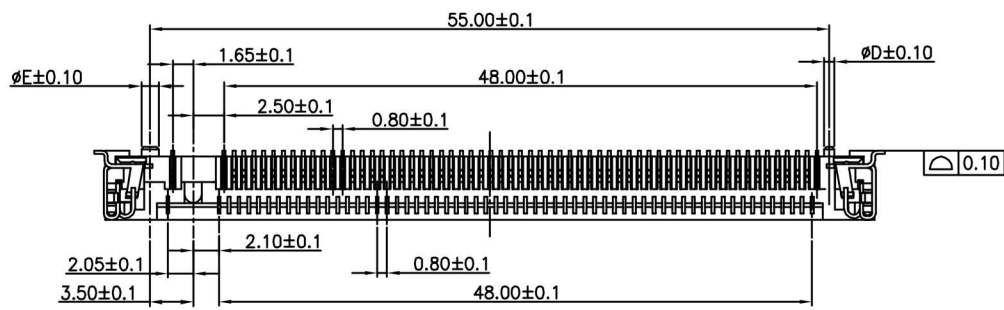

B-B' SECTION

P/N	STAND-OFF (mm)				
	H	A	B	C	D
13169-XXXX-052-X	5.2	2.74	0.1	3.30	0.85
13169-XXXX-056-X	5.6	3.14	0.5	3.70	
13169-XXXX-060-X	6.0	3.54	0.9	4.10	1.40
13169-XXXX-068-X	6.8	4.34	1.7	4.90	
13169-XXXX-080-X	8.0	5.52	0.3	6.08	0.93
13169-XXXX-092-X	9.2	6.74	0.3	7.30	

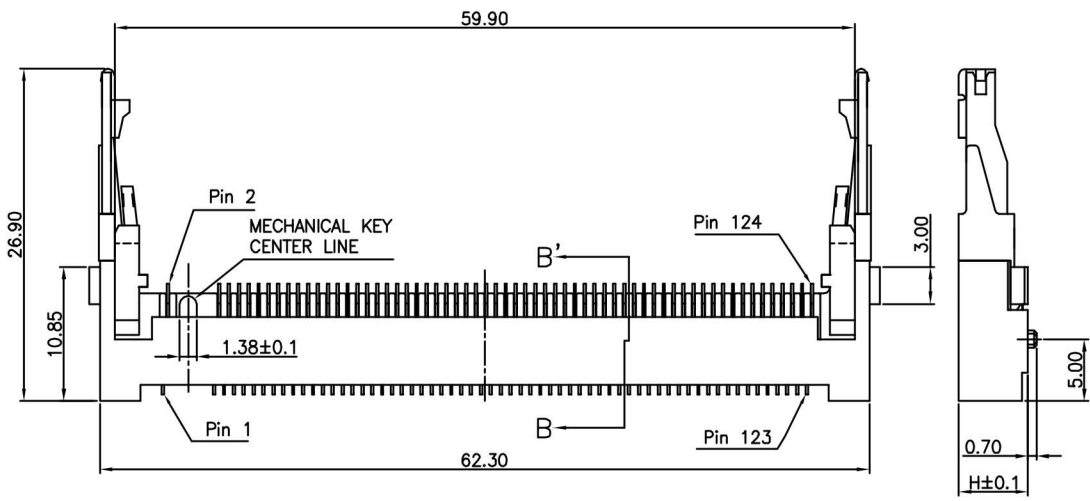

- NOTES: 1. MATERIAL:
 1-1 HOUSING: HIGH TEMPERATURE THERMO PLASTIC
 UL94V-0 RATED, COLOR SEE SEE P/N
 1-2 CONTACT: COPPER ALLOY.
 1-3 SOLDER TAB & LATCH: COPPER ALLOY
 2. CONTACT FINISH:
 2-1 GOLD PLATING ON CONTACT AREA, SEE P/N
 2-2 GOLD FLASH ON SOLDERING AREA
 2-3 ALL OVER 40u" MIN. NICKEL UNDER PLATED
 3. GENERAL TOLERANCE: ±0.3
 4. PACKING: SEE P/N
 5. PART NUMBER: 13169-XXXX-OXX-X/B
- | | |
|------------------|-----------------------|
| LOGO | PACKING |
| 1: W/ LOGO | 1: TRAY |
| 2: W/O LOGO | 3: TAPE & REEL |
| COLOR OF HOUSING | PRODUCT HEIGHT |
| A: IVORY | 052: 5.2 MM HEIGHT |
| B: BLACK | 056: 5.6 MM HEIGHT |
| CONTACT PLATING | 060: 6.0 MM HEIGHT |
| 0: GOLD FLASH | 068: 6.8 MM HEIGHT |
| 1: 5u" GOLD | 080: 8.0 MM HEIGHT |
| 2: 30u" GOLD | 092: 9.2 MM HEIGHT |
| 3: 3u" GOLD | SOLDER TAB & LATCH |
| 4: 10u" GOLD | STRUCTURE (PLATING) |
| 5: 15u" GOLD | A: NORMAL (LEAD FREE) |

SoniTexx[®]

INTENDED USE	TITLE	Mini PCI Connector, 0.8mm Pitch 124 Pin 5.2/5.6/6.0/6.8/8.0/9.2mm Height		
CUSTOMER	PART NO.	13169-XXXX-OXX-X	APPRO	William
TOLERANCES	DRAW NO.	13169-XXXX-OXX-X	CHKD	Arthurx
0~6±0.1 X.*±1.5* 6~20±0.2 .X*±1* 20~90±0.3.XX*±0.5*	MATERIAL	SEE NOTE	DRAW	Tina
	FINISH	SEE NOTE	DATE	08/04/29
	SCALE	SHEET	REV	UNIN
	1:1	1/1	A	mm

1 2 3 4 5 6 7 8