

| REV. | ECN NO./DESCRIPTION | DATE |
|------|---------------------|------------|
| 1 | N100069 | 03/08'2010 |
| 2 | N100134 | 04/23'2010 |

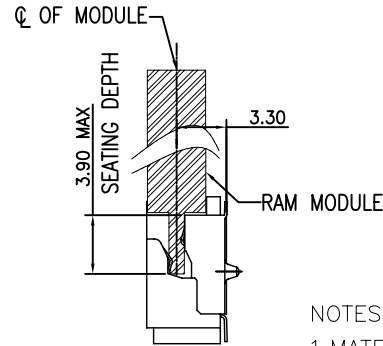
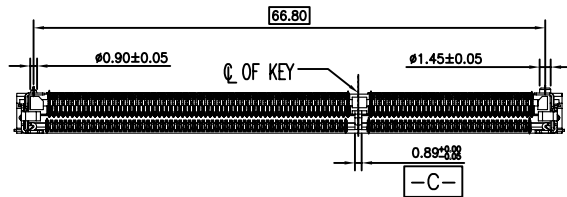

SECTION A-A
SCALE 2:1

NOTES:

- MATERIAL SPECIFICATION,
 - HOUSING:HIGH TEMPERATURE THERMO PLASTIC,UL94_V0
COLOR:BLACK OR WHITE
 - CONTACTS:COPPER ALLOY
 - STATOR:STAINLESS STEEL.
 - LATCH:STAINLESS STEEL
- PLATING SPECIFICATION,
 - CONTACT:GOLD PLATED Min IN CONTACT AREA(SEE TABLE).
TIN(MATTE) OR GOLD PLATED Min IN SOLDERING AREA,
NICKEL UNDERPLATING ALL OVER.
 - STATOR:TIN(MATTE) OVER,NICKEL UNDERPLATING ALL OVER.
- AAA-DDR-110-K**:RoHS COMPLIANT
AAA-DDR-110-P**:HF COMPLIANT

TABLE:

| NO. | PART NO. | CONTACT AREA | SOLDER TAIL | HOUSING | PACKAGE | VOLTAGE |
|-----|-------------------|--------------|-------------|---------|---------|---------|
| 11 | AAA-DDR-110-P10 | Au3u" | Sn | BLACK | REEL | 1.5V |
| 10 | AAA-DDR-110-K09 | Au2u" | Sn | BLACK | REEL | 1.5V |
| 9 | AAA-DDR-110-P08 | Au10u" | Sn | WHITE | REEL | 1.5V |
| 8 | AAA-DDR-110-P07 | Au15u" | Sn | WHITE | REEL | 1.5V |
| 7 | AAA-DDR-110-P06 | Au15u" | G/F | BLACK | REEL | 1.5V |
| 6 | AAA-DDR-110-P05 | G/F | Sn | WHITE | REEL | 1.5V |
| 5 | AAA-DDR-110-K04 | Au15u" | Sn | BLACK | REEL | 1.5V |
| 4 | AAA-DDR-110-K03 | Au30u" | Sn | BLACK | REEL | 1.5V |
| 3 | AAA-DDR-110-P01_A | G/F | Sn | BLACK | TRAY | 1.5V |
| 2 | AAA-DDR-110-P01 | G/F | Sn | BLACK | REEL | 1.5V |
| 1 | AAA-DDR-110-K01 | G/F | Sn | BLACK | REEL | 1.5V |

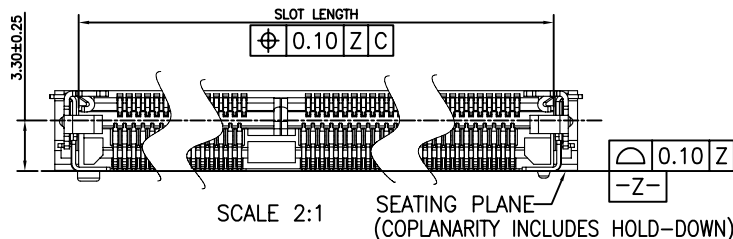
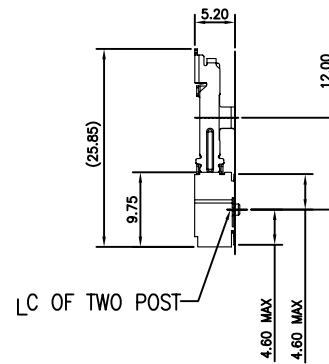
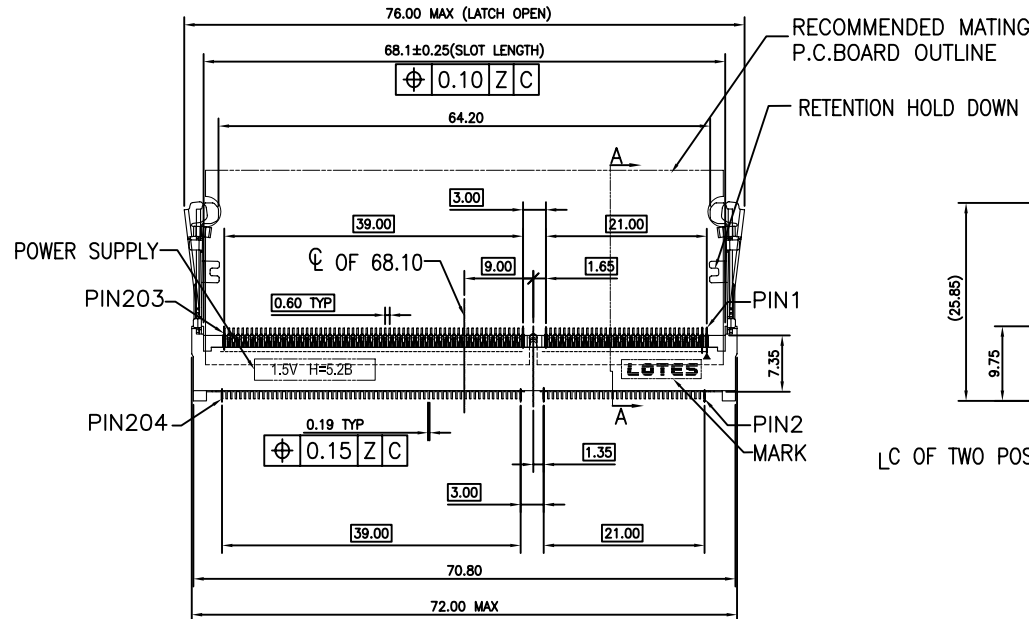

| GENERAL TOLERANCES UNLESS SPECIFIED | | PART NO. | LOTES | | |
|-------------------------------------|-------------------|---------------------------------|-------------------------------|--------------|----------|
| .X ± 0.35 | X° ± 3° | SEE TABLE | TITLE SO.DDR3 5.2H B CONN. | | |
| .XX ± 0.25 | .X° ± 2° | APPROVED BY Smark | | | |
| .XXX ± 0.15 | .XX° ± 1° | CHECKED BY Joe | | | |
| CUSTOMER DRAWING | | DRAWN BY JACK LIU 04/23'2010 | DWG NO. GAP-AAA-DDR-110 | | |
| SIZE A4 | UNITS MM[INCH] | | SHEET 1 / 5 | SCALE 1:1 | REV 2 |

| REV. | ECN NO./DESCRIPTION | DATE |
|------|---------------------|------------|
| 1 | N100069 | 03/08'2010 |
| 2 | N100134 | 04/23'2010 |

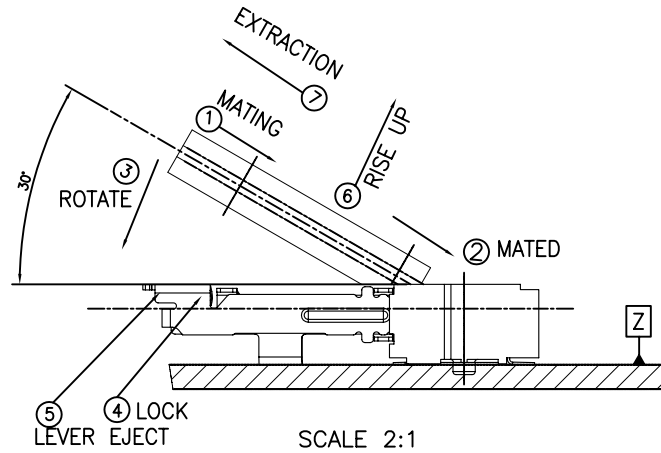

HOW TO MATE AND UNMATE

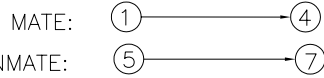

30° MAX. MODULE INSERTION ANGLE TO ENGAGE LATCH

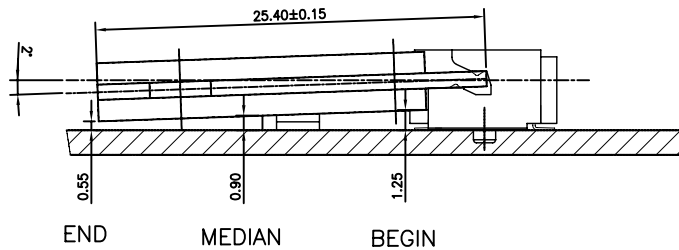

SCALE 2:1

2° MAX. MODULE OVERLOAD ANGLE TO ENGAGE LATCH.
 MAXIMUM RECOMMENDED COMPONENT HEIGHT ALLOWED ON MOTHERBOARD.

| | | |
|----------------------------|--------|-------|
| MAX.MOUDULE HEIGHT=25.55mm | | |
| END | MEDIAN | BEGIN |
| 0.55 | 0.90 | 1.25 |

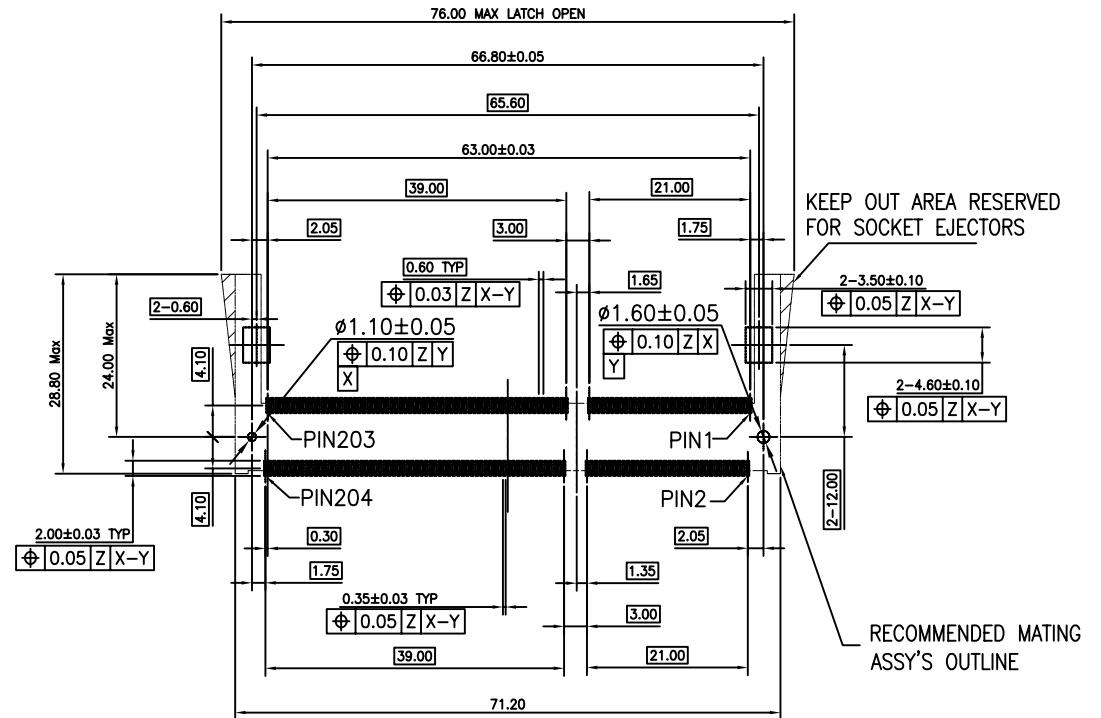

RECOMMENDED PCB LAYOUT(TOP VIEW)

RECOMMENDED PCB THICKNESS:1.60±0.10MM

DEFAULT TOLERANCE ±0.05MM

| | | | | |
|-------------------------------------|-----------|---------------------|--|----------------------|
| GENERAL TOLERANCES UNLESS SPECIFIED | | PART NO. | | LOTES |
| .X ± 0.35 | X° ± 3° | SEE TABLE | | |
| .XX ± 0.25 | .X° ± 2° | APPROVED BY | | TITLE |
| .XXX ± 0.15 | .XX° ± 1° | Smark | | SO.DDR3 5.2H B CONN. |
| CUSTOMER DRAWING | | CHECKED BY | | DWG NO. |
| | | Joe | | GAP-AAA-DDR-110 |
| SIZE | UNITS | DRAWN BY | | SHEET SCALE REV |
| A4 | MM[INCH] | JACK LIU 04/23'2010 | | |

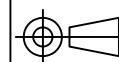

| | | |
|-------|-----|---|
| 2 / 5 | 1:1 | 2 |
|-------|-----|---|

| REV. | ECN NO./DESCRIPTION | DATE |
|------|---------------------|------------|
| 1 | N100069 | 03/08'2010 |
| 2 | N100134 | 04/23'2010 |

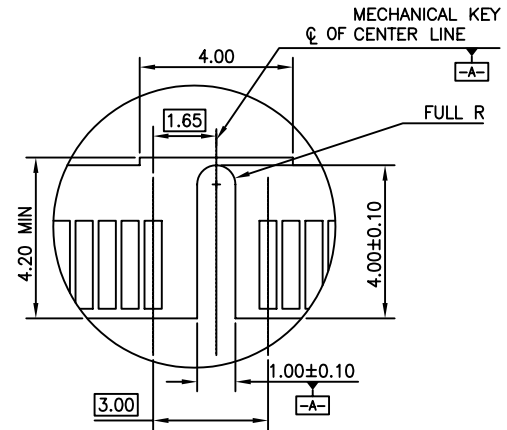
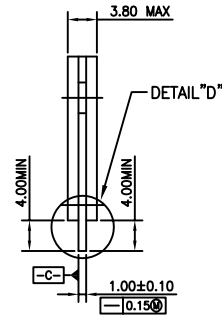
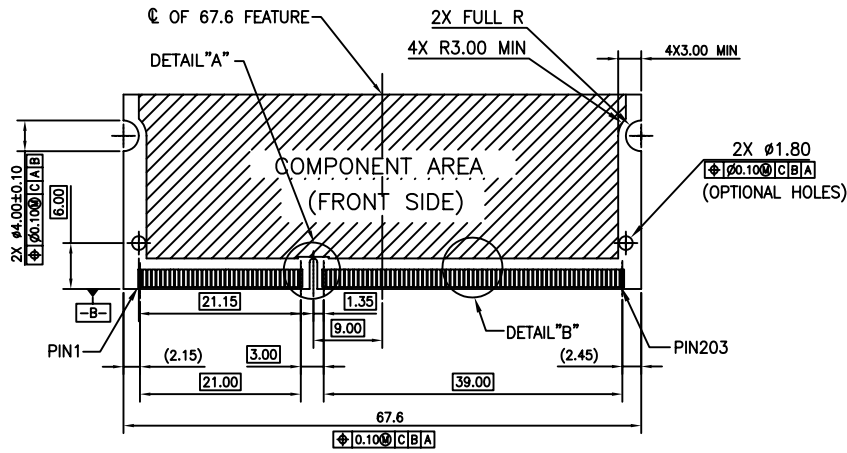

DETAIL A
SCALE 5:1

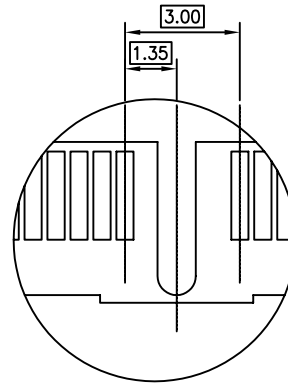
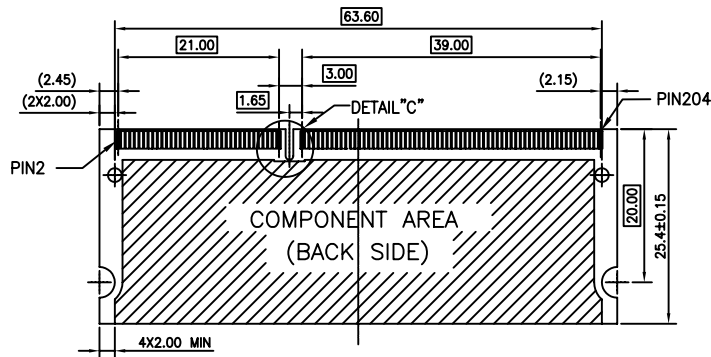

DETAIL C (BACK SIDE)
SCALE 5:1

RECOMMENDED MATING P.C.B CONFIGURATION
RECOMMENDED P.C.B THICKNESS: 1.00±0.05MM
DEFAULT TOLERANCE ±0.05MM

NOTES:

- TOLERANCE ON ALL DIMENSIONS ±0.15 UNLESS OTHERWISE SPECIFIED;
- PCB THICKNESS APPLIES ACROSS TABS AND INCLUDES PLATING AND/OR METALIZATION;
- FINISH OF PAD: Au PLATING 0.05-0.75um, OVER Ni PLATING 2um min;

- NO BURR;
- CHAMFER 0.25mm MAX. X 45° IF EXIST.

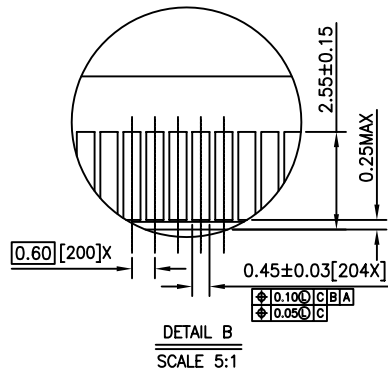

DETAIL B
SCALE 5:1

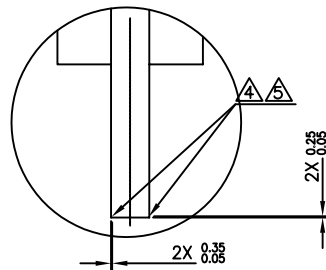

DETAIL "D"
SCALE 5:1

| GENERAL TOLERANCES UNLESS SPECIFIED | | PART NO. | LOTES | | |
|-------------------------------------|---------------------------------|----------------------|----------------------------|--|--|
| .X ± 0.35 | X° ± 3° | SEE TABLE | | | |
| .XX ± 0.25 | .X° ± 2° | APPROVED BY Smark | DWG NO. GAP-AAA-DDR-110 | | |
| .XXX ± 0.15 | .XX° ± 1° | CHECKED BY Joe | | | |
| CUSTOMER DRAWING | DRAWN BY JACK LIU 04/23'2010 | SCALE 1:1 | REV 2 | | |
| SIZE A4 | UNITS MM [INCH] | | | | |

| REV. | ECN NO./DESCRIPTION | DATE |
|------|---------------------|------------|
| 1 | N100069 | 03/08'2010 |
| 2 | N100134 | 04/23'2010 |

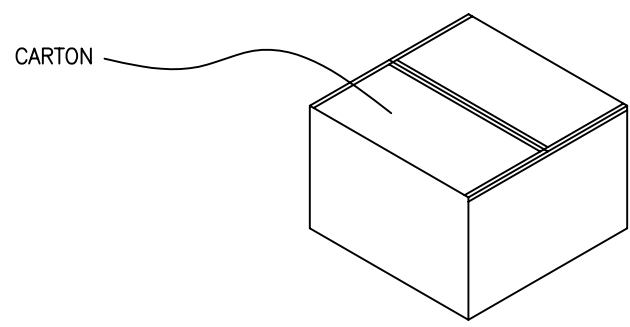
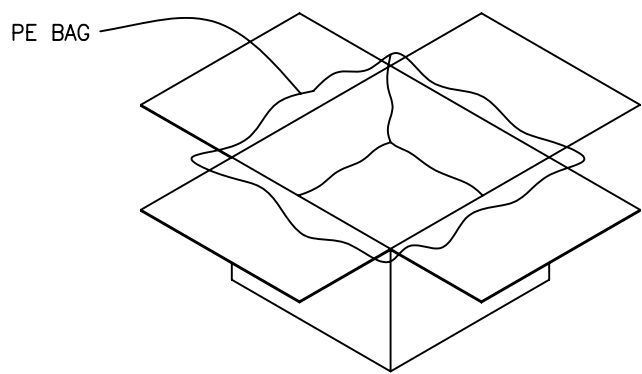
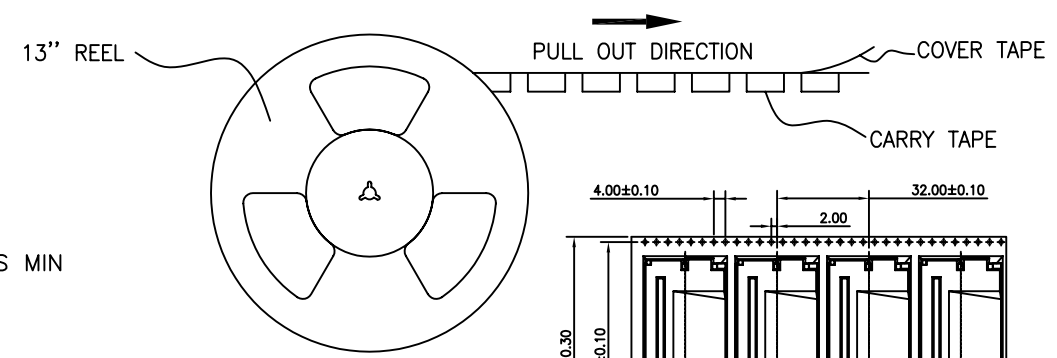
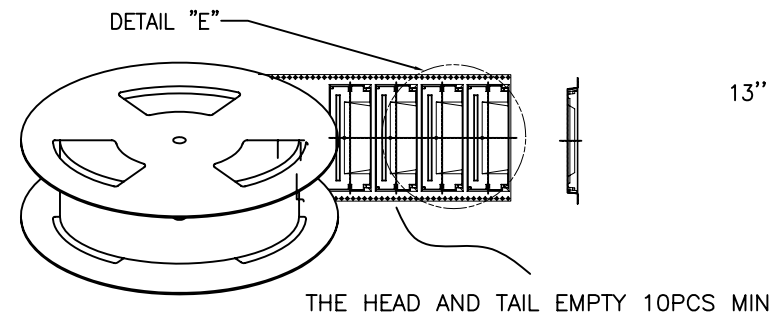

NOTES:
 1.THE OPERATION OF PACKING REFER THE LEFT PROCESS.
 2.PACKING LIST.

| DESCRIPTION | P/N | SPECIFICATION | QT'Y |
|----------------|-----------------|---------------------|--------|
| SODDR ASS'Y | SEE TABLE | 5.2H REEL PACKING | 450PCS |
| REEL | G09-4-30008-101 | 13";W=88;PS_BLUE | 3PCS |
| CARRIER TAPE | G09-6-00043-101 | 5.8*88 ESD PS_BLACK | 16.32M |
| COVER TAPE | G09-5-00018-101 | HOT JOINT W=82.4 | 16.32M |
| PE BAG | G09-6-50002-101 | L520*W320*H460 | 1PCS |
| FOAM | G09-8-30002-102 | L320*W320*H10 | 4PCS |
| CARTON | G09-1-30010-101 | L335*W335*H300; B=C | 1PCS |
| INSIDER CARTON | | | |

| | | | | | |
|-------------------------------------|-------------------|---------------------------------|-------------------------------|--------------|----------|
| GENERAL TOLERANCES UNLESS SPECIFIED | | PART NO. SEE TABLE | LOTES | | |
| .X± 0.35 | X.°± 3° | | | | |
| .XX± 0.25 | X.°± 2° | APPROVED BY Smark | TITLE SO.DDR3 5.2H B CONN. | | |
| .XXX± 0.15 | .XX°± 1° | CHECKED BY Joe | DWG NO. GAP-AAA-DDR-110 | | |
| CUSTOMER DRAWING | | DRAWN BY JACK LIU 04/23'2010 | SHEET 4 / 5 | SCALE 1:1 | REV 2 |
| SIZE A4 | UNITS MM[INCH] | | | | |

| REV. | ECN NO./DESCRIPTION | DATE |
|------|---------------------|------------|
| 1 | N100069 | 03/08'2010 |
| 2 | N100134 | 04/23'2010 |

PE BAG

CARTON

318±2.00

THE 36PCS TRAY INTO CARTON

228±2.00

TRAY:18PCS/TRAY
 CARTON:36TRAY/CATRON
 CARTON:35TRAY/CARTON*18PCS/TRAY=630PCS/CARTON

1.PACKING LIST.

| DESCRIPTION | P/N | SPECIFICATION | QT'Y |
|----------------|-----------------|---------------------|--------|
| SODDR ASS'Y | SEE TABLE | 5.2H TRAY PACKING | 630PCS |
| TRAY | G09-A-30079-101 | 318mm*228mm PET | 36PCS |
| PE BAG | G09-6-50002-101 | L520*W320*H460 | 1PCS |
| PAPER BOARD | G09-3-30014-101 | L320mm*W230mm*H5mm | 1PCS |
| CARTON | G09-1-30033-101 | L324*W234*H310; B=C | 1PCS |
| INSIDER CARTON | | | |

| GENERAL TOLERANCES UNLESS SPECIFIED | | PART NO. | LOTES | | | |
|-------------------------------------|----------|---------------------|----------------------|-------|-------|-----|
| .X± 0.35 | X°± 3° | SEE TABLE | TITLE | | | |
| .XX± 0.25 | .X°± 2° | APPROVED BY | SO.DDR3 5.2H B CONN. | | | |
| .XXX± 0.15 | .XX°± 1° | Smark | DWG NO. | | | |
| CUSTOMER DRAWING | | CHECKED BY | GAP-AAA-DDR-110 | | | |
| | | Joe | | | | |
| SIZE | UNITS | DRAWN BY | | SHEET | SCALE | REV |
| A4 | MM[INCH] | JACK LIU 04/23'2010 | | 5 / 5 | 1:1 | 2 |