

REV.	ECN NO./DESCRIPTION	DATE
1	N100069	03/08'2010
2	N100134	04/23'2010

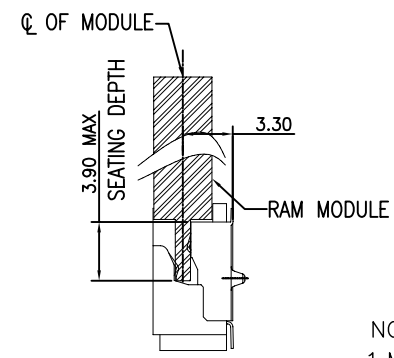

SECTION A-A
SCALE 2:1

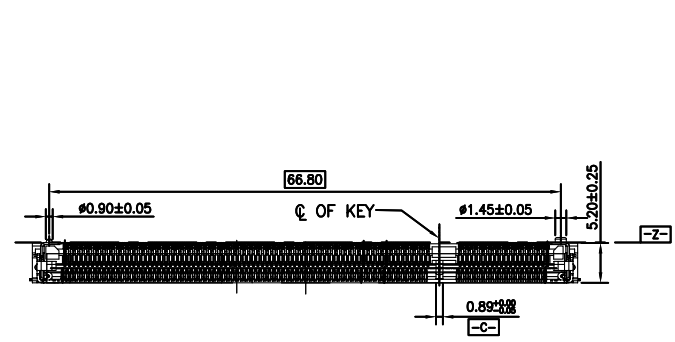
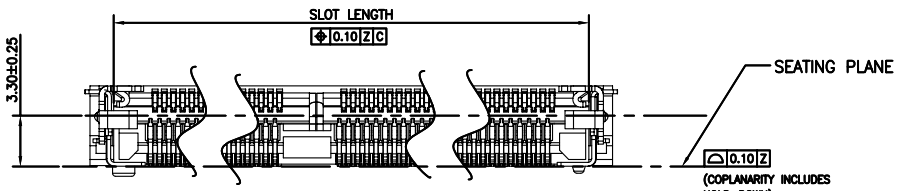
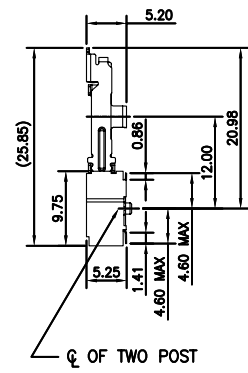
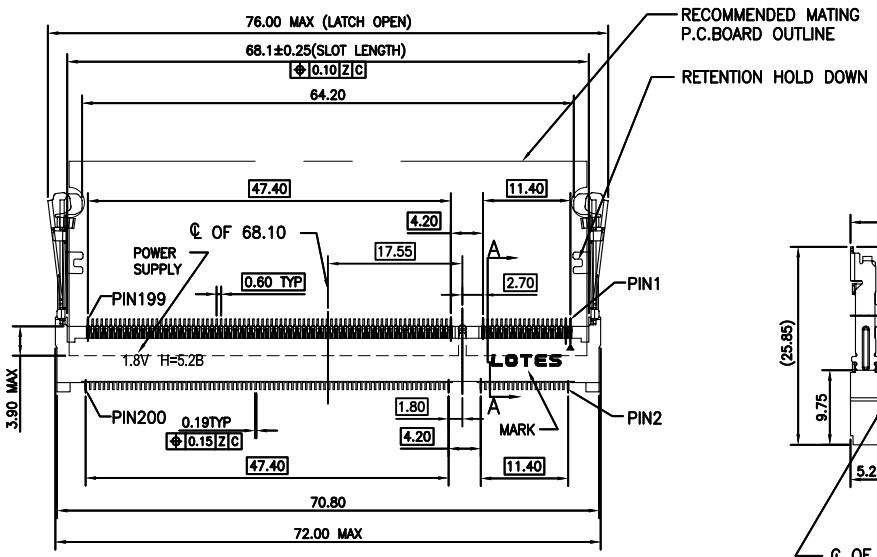

SCALE 2:1

- NOTES:
- MATERIAL SPECIFICATION,
 - HOUSING:HIGH TEMPERATURE THERMO PLASTIC,UL94_V0 COLOR:BLACK OR WHITE
 - CONTACTS:COPPER ALLOY
 - STATOR:STAINLESS STEEL.
 - LATCH:STAINLESS STEEL
 - PLATING SPECIFICATION,
 - CONTACT:GOLD PLATED Min IN CONTACT AREA(SEE TABLE). TIN(MATTE) OR GOLD PLATED Min IN SOLDERPNG AREA, NICKEL UNDERPLATING ALL OVER.
 - STATOR:TIN(MATTE) OVER,NICKEL UNDERPLATING ALL OVER.
 - AAA-DDR-102-P**:HF COMPLIANT
AAA-DDR-102-K**:RoHS COMPLIANT

TABLE:

NO.	PART NO.	PLATING	HOUSING	PACKAGE	VOLTAGE
11	AAA-DDR-102-K10	Contact Area:Au2u",Solder tail:Sn	Black	REEL	1.8V
10	AAA-DDR-102-P09	Contact Area:Au3u",Solder tail:Sn	Black	REEL	1.8V
9	AAA-DDR-102-K07	Contact Area:Au10u",Solder tail:Sn	Black	REEL	1.8V
8	AAA-DDR-102-K06	Contact Area:G/F,Solder tail:Sn	White	REEL	1.8V
7	AAA-DDR-102-P05	Contact Area:Au30u",Solder tail:Sn	Black	REEL	1.8V
6	AAA-DDR-102-K05	Contact Area:Au15u",Solder tail:Sn	Black	REEL	1.8V
5	AAA-DDR-102-P03	Contact Area:Au15u",Solder tail:Sn	Black	REEL	1.8V
4	AAA-DDR-102-K03	Contact Area:Au30u",Solder tail:Sn	Black	REEL	1.8V
3	AAA-DDR-102-P01_A	Contact Area:G/F,Solder tail:Sn	Black	TRAY	1.8V
2	AAA-DDR-102-P01	Contact Area:G/F,Solder tail:Sn	Black	REEL	1.8V
1	AAA-DDR-102-K01	Contact Area:G/F,Solder tail:Sn	Black	REEL	1.8V

GENERAL TOLERANCES UNLESS SPECIFIED		PART NO.	LOTES			
.X ± 0.35	X° ± 3°	SEE TABLE				
.XX ± 0.25	X° ± 2°	APPROVED BY	TITLE			
.XXX ± 0.15	.XX° ± 1°	Smark	SO.DDR2 5.2H B CONN.			
CUSTOMER DRAWING		CHECKED BY	DWG NO.			
		Joe	GAP-AAA-DDR-102			
SIZE	UNITS	DRAWN BY		SHEET	SCALE	REV
A4	MM[INCH]	JACK LIU 04/23'2010		1 / 5	1:1	2

REV.	ECN NO./DESCRIPTION	DATE
1	N100069	03/08'2010
2	N100134	04/23'2010

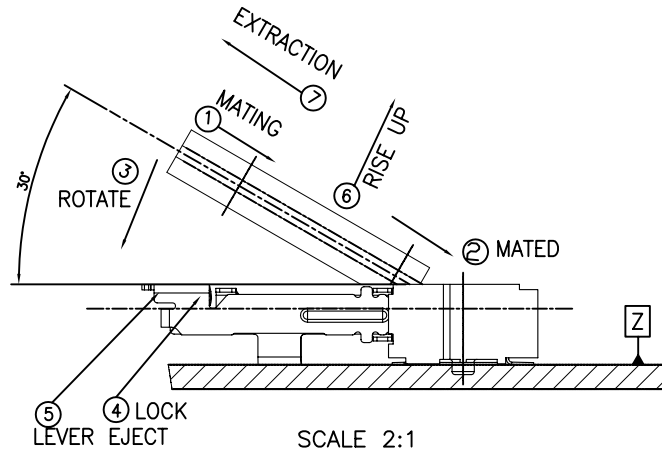

HOW TO MATE AND UNMATE

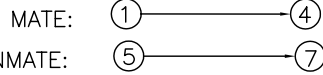

30° MAX. MODULE INSERTION ANGLE TO ENGAGE LATCH

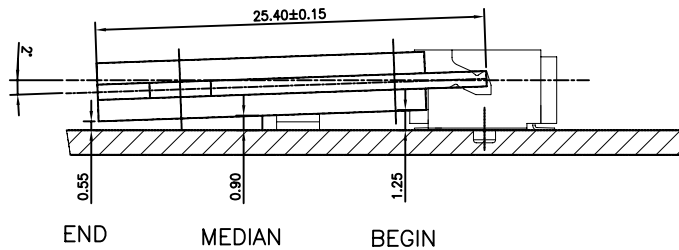

2° MAX. MODULE OVERLOAD ANGLE TO ENGAGE LATCH.
 MAXIMUM RECOMMENDED COMPONENT HEIGHT ALLOWED ON MOTHERBOARD.

MAX.MOUDULE HEIGHT=25.55mm		
END	MEDIAN	BEGIN
0.55	0.90	1.25

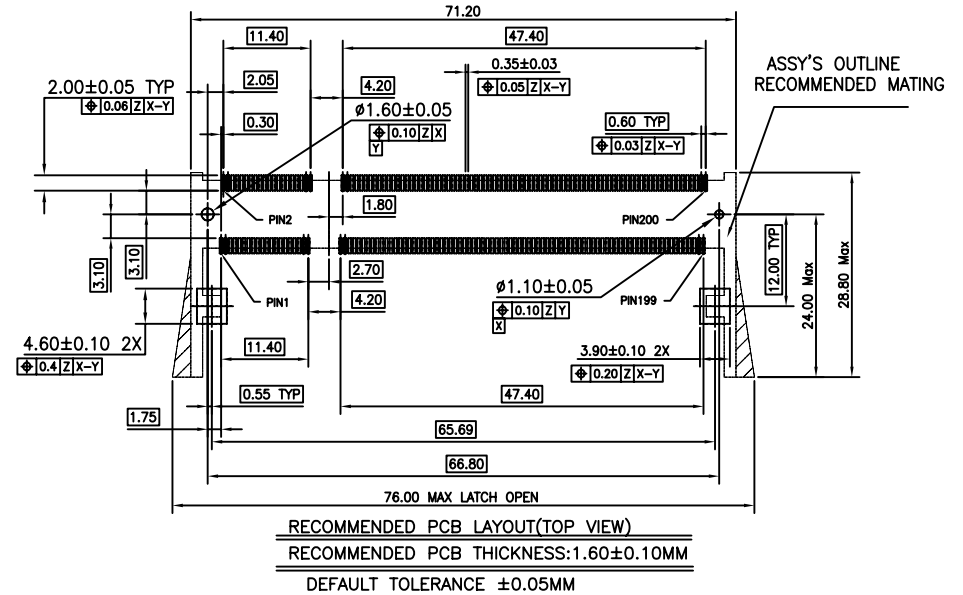

RECOMMENDED PCB LAYOUT(TOP VIEW)
 RECOMMENDED PCB THICKNESS:1.60±0.10MM
 DEFAULT TOLERANCE ±0.05MM

GENERAL TOLERANCES UNLESS SPECIFIED		PART NO. SEE TABLE	LOTES		
.X ± 0.35	X.° ± 3°				
.XX ± 0.25	.X.° ± 2°	APPROVED BY Smark	TITLE SO.DDR2 5.2H B CONN.		
.XXX ± 0.15	.XX.° ± 1°	CHECKED BY Joe	DWG NO. GAP-AAA-DDR-102		
CUSTOMER DRAWING		DRAWN BY JACK LIU 04/23'2010	SHEET 2 / 5	SCALE 1:1	REV 2
SIZE A4	UNITS MM[INCH]				

REV.	ECN NO./DESCRIPTION	DATE
1	N100069	03/08'2010
2	N100134	04/23'2010

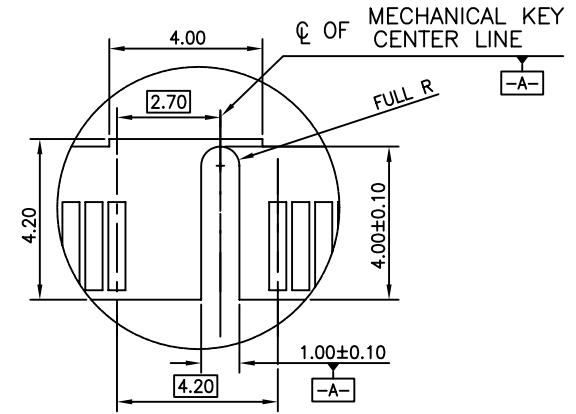
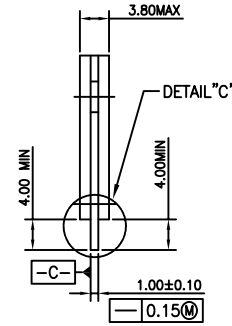
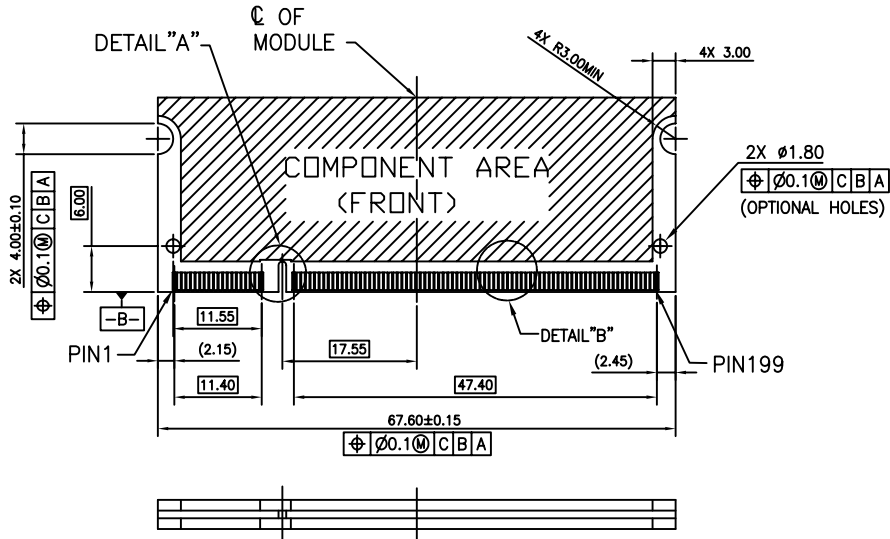

DETAIL A
 SCALE 5:1

RECOMMENDED MATING P.C.B CONFIGURATION
 RECOMMENDED P.C.B THICKNESS: 1.00 ± 0.05 MM
 DEFAULT TOLERANCE ± 0.05 MM

NOTES:

- 1.PCB THICKNESS APPLIES ACROSS TABS AND INCLUDES PLATING AND/OR METALIZATION;
 - 2.FINISH OF PAD: Au PLATING 0.76 μ m min, OVER Ni PLATING 2 μ m min;
- △NO BURR;
 ▴CHAMFER 0.25mm MAX. X 45° IF EXIST.

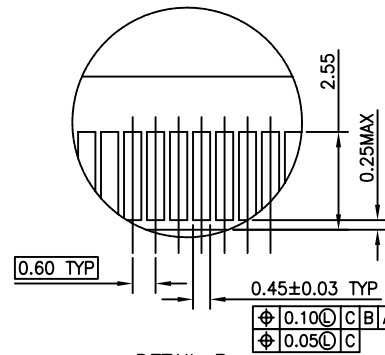
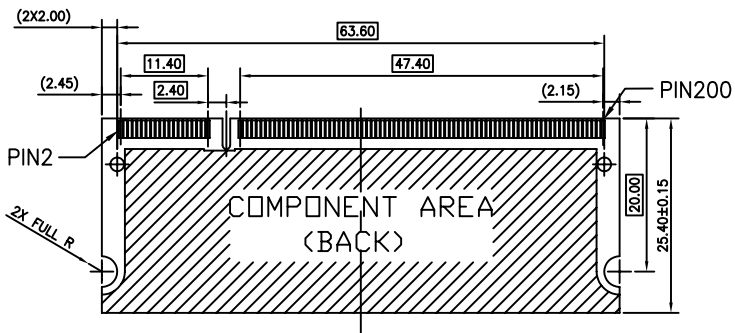

DETAIL B
 SCALE 5:1

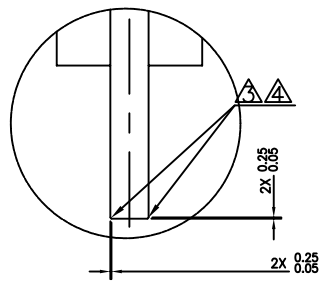

DETAIL "C"
 SCALE 5:1

GENERAL TOLERANCES UNLESS SPECIFIED		PART NO.	LOTES		
.X \pm 0.35	X. $^\circ$ \pm 3 $^\circ$	SEE TABLE			
.XX \pm 0.25	X. $^\circ$ \pm 2 $^\circ$	APPROVED BY	TITLE		
.XXX \pm 0.15	.XX $^\circ$ \pm 1 $^\circ$	Smark	SO.DDR2 5.2H B CONN.		
CUSTOMER DRAWING		CHECKED BY	DWG NO.		
		Joe	GAP-AAA-DDR-102		
SIZE	UNITS	DRAWN BY	SHEET	SCALE	REV
A4	MM[INCH]	JACK LIU 04/23'2010			

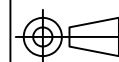

3 / 5	1:1	2
-------	-----	---

REV.	ECN NO./DESCRIPTION	DATE
1	N100069	03/08'2010
2	N100134	04/23'2010

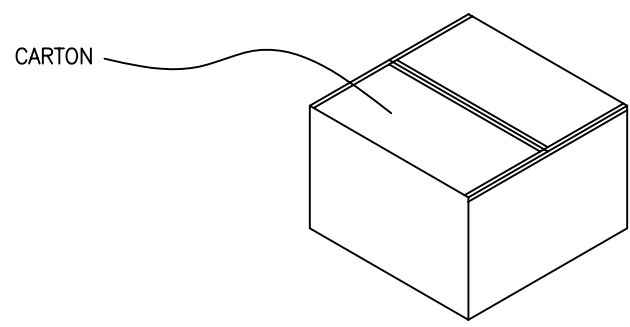
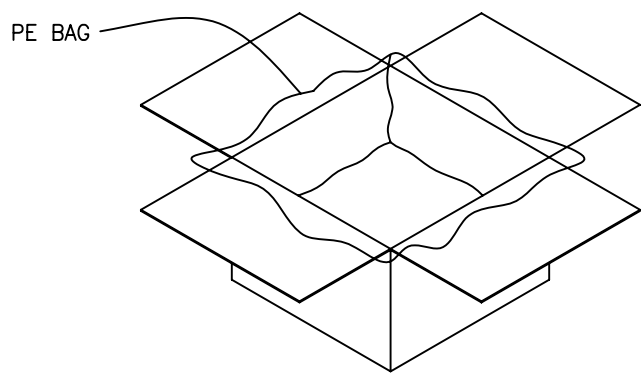
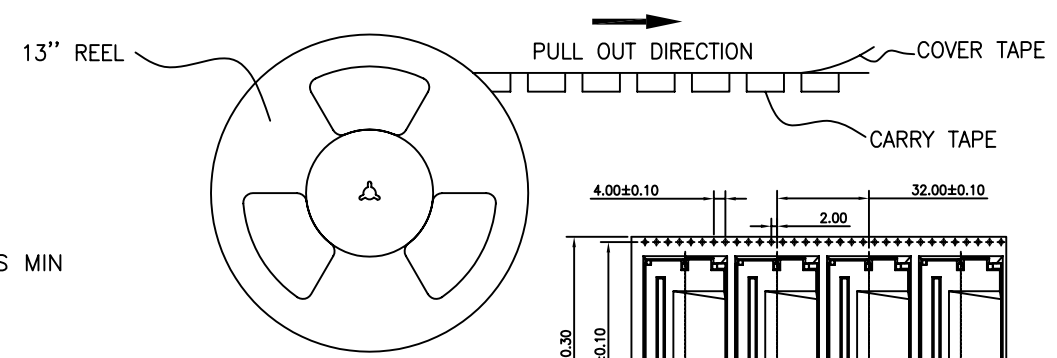
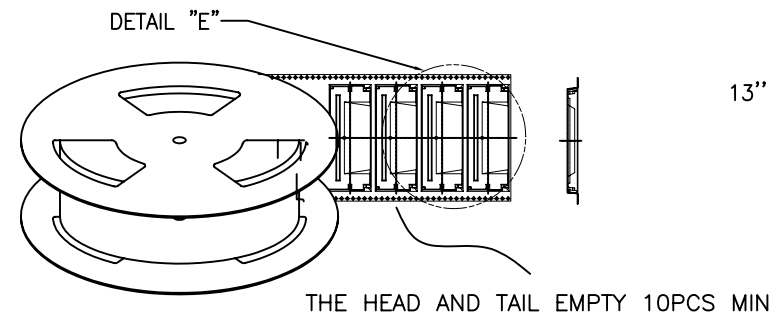

NOTES:
 1.THE OPERATION OF PACKING REFER THE LEFT PROCESS.
 2.PACKING LIST.

DESCRIPTION	P/N	SPECIFICATION	QT'Y
SODDR ASS'Y	SEE TABLE	5.2H REEL PACKING	450PCS
REEL	G09-4-30008-101	13";W=88;PS_BLUE	3PCS
CARRIER TAPE	G09-6-00043-101	5.8*88 ESD PS_BLACK	16.32M
COVER TAPE	G09-5-00018-101	HOT JOINT W=82.4	16.32M
PE BAG	G09-6-50002-101	L520*W320*H460	1PCS
FOAM	G09-8-30002-102	L320*W320*H10	4PCS
CARTON	G09-1-30010-101	L335*W335*H300; B=C	1PCS
INSIDER CARTON			

GENERAL TOLERANCES UNLESS SPECIFIED		PART NO. SEE TABLE	LOTES		
.X± 0.35	X°± 3°				
.XX± 0.25	X°± 2°	APPROVED BY Smark	TITLE SO.DDR2 5.2H B CONN.		
.XXX± 0.15	.XX°± 1°	CHECKED BY Joe	DWG NO. GAP-AAA-DDR-102		
CUSTOMER DRAWING		DRAWN BY JACK LIU 04/23'2010	SHEET 4 / 5	SCALE 1:1	REV 2
SIZE A4	UNITS MM[INCH]				

REV.	ECN NO./DESCRIPTION	DATE
1	N100069	03/08'2010
2	N100134	04/23'2010

PE BAG

CARTON

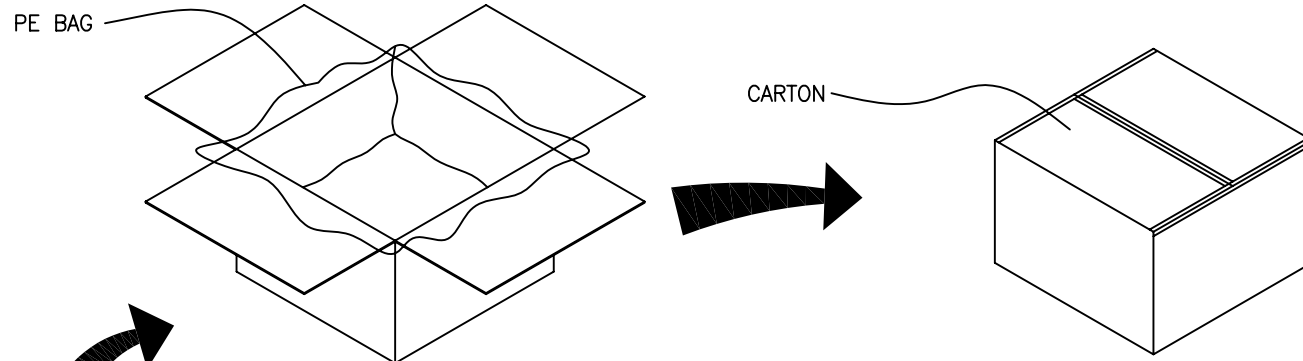

THE 36PCS TRAY INTO CARTON

318±2.00

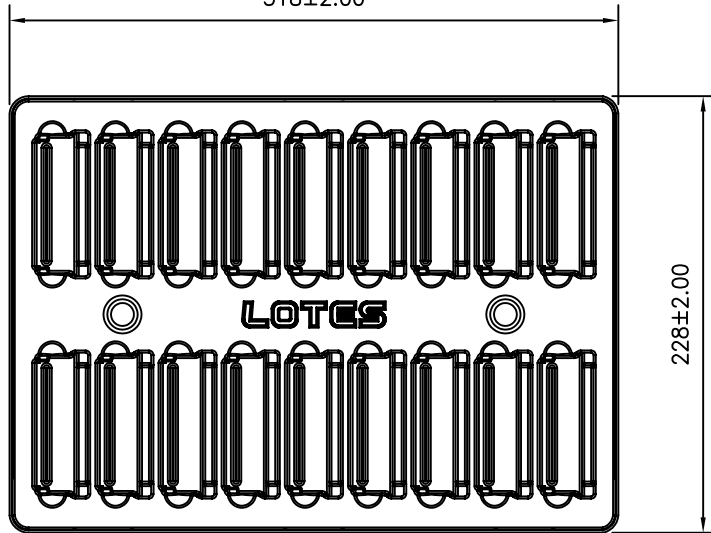

228±2.00

TRAY:18PCS/TRAY
 CARTON:36TRAY/CATRON
 CARTON:35TRAY/CARTON*18PCS/TRAY=630PCS/CARTON

1.PACKING LIST.

DESCRIPTION	P/N	SPECIFICATION	QT'Y
SODDR ASS'Y	SEE TABLE	5.2H TRAY PACKING	630PCS
TRAY	G09-A-30079-101	318mm*228mm PET	36PCS
PE BAG	G09-6-50002-101	L520*W320*H460	1PCS
PAPER BOARD	G09-3-30014-101	L320mm*W230mm*H5mm	1PCS
CARTON	G09-1-30033-101	L324*W234*H310; B=C	1PCS
INSIDER CARTON			

GENERAL TOLERANCES UNLESS SPECIFIED		PART NO.	LOTES		
.X± 0.35	X°± 3°	SEE TABLE	TITLE SO.DDR2 5.2H B CONN.		
.XX± 0.25	.X°± 2°	APPROVED BY Smark	DWG NO. GAP-AAA-DDR-102		
.XXX± 0.15	.XX°± 1°	CHECKED BY Joe	DRAWN BY JACK LIU 04/23'2010		
CUSTOMER DRAWING					
SIZE A4	UNITS MM[INCH]			SHEET 5 / 5	SCALE 1:1
				REV 2	